

**Requirements**

Strength class; C28/35

V<sub>ct</sub>; "water/cement ratio":  
0,55

Consistency class S3

Exponeringsklass; Exposure  
class: XC4, XF3

Aggregate:  
Max stone size. 8 mm

Protective equipment  
should be used during  
casting

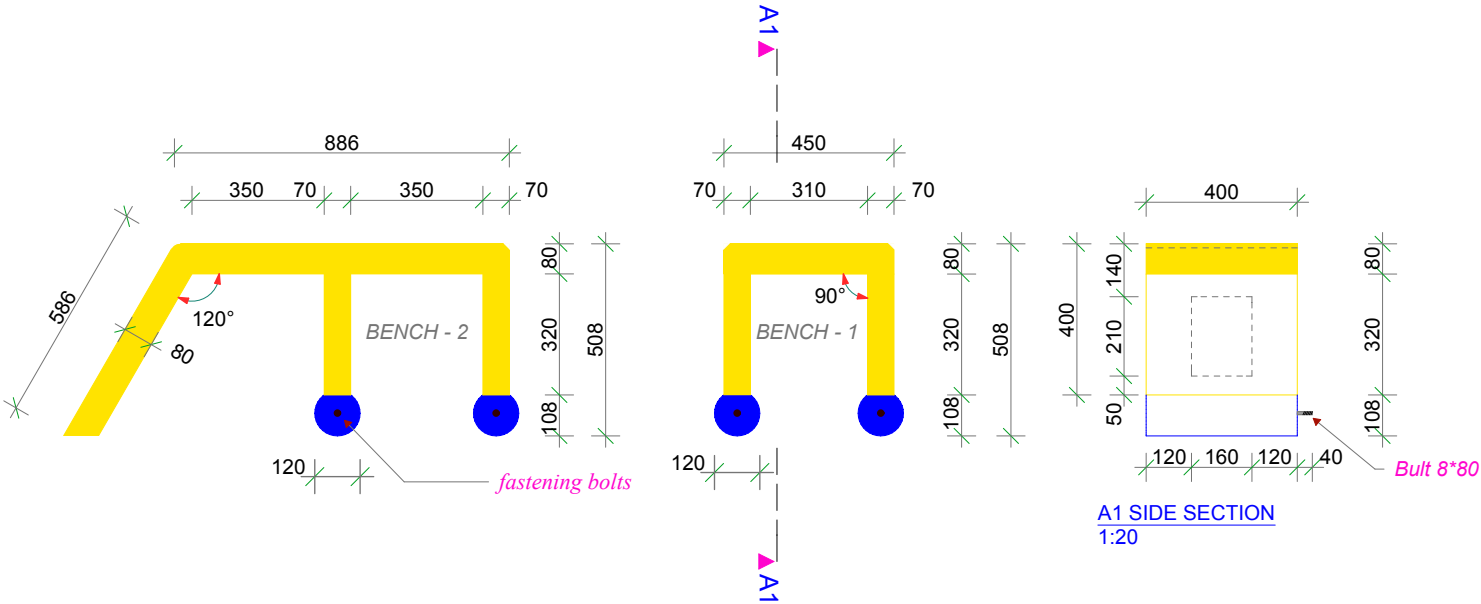

Skill name: <b>CONCRETE CONSTRUCTION WORK</b>	Drawn by: Vahik Bedrosian	Constructed by: Vahik Bedrosian
Event: <b>ES 2016 - GOTHENBURG</b>	Scale: 1:20	Date: 19/12/16
Besskrivning: <b>CONCRETE MEASURMENTS</b>	Drawing number: K - 40 - C01	IND